

CONAIRMAN™



THE CLEAN CUT

TOOL TIPS

for the essential hair clipping kit with
colour-coded guides for a perfect cut, every time.

VSM732CA

HERE YOU ARE.

RIGHT WHERE YOU NEED TO BE, MAN.

FROM THE STREETS OF
BROOKLYN, NEW YORK

**WE ARE CHANGE
MAKERS & STYLE CREATORS.**

WE'VE FOUGHT OUR WAY INTO
YOUR HANDS TO HELP YOU CRAFT

**A REPUTATION, NOT JUST ENGAGE
IN SOME BRILLIANT GROOMING.**

KNOW YOUR WORTH, INVEST IN IT MAN & CHECK OUT OUR INSIDER
KNOWLEDGE, TIPS & TRICKS TO MAKE THE MOST OF THE STYLE PATH
YOUR FEET ARE FIRMLY PLANTED ON. GIDDY UP, IT'S GROOMING TIME.

CHECK OUT CONAIRMAN.COM.AU FOR GROOMING TIPS
& KNOW HOW TO LET YOU CRAFT A REPUTATION

CONAIRMAN™

**CRAFT A
REPUTATION,
MY MAN**

IMPORTANT SAFETY INSTRUCTIONS

When using electrical appliances, especially when children are present, basic safety instructions should always be followed, including the following:

Polythene bags over product or package may be dangerous. To avoid danger of suffocation, keep this wrapper away from babies and children. This bag is not a toy.

DANGER: When the unit is used in a bathroom, unplug it after use since the proximity of water presents a hazard even when the appliance is switched off



WARNING: Do not use or leave the adaptor in a position where it can become wet or there is a danger of it falling into a basin or other vessels containing water. Keep the appliance dry, unless it otherwise specified. Do not use this appliance in or near bathtubs, showers, basins or other vessels containing water.

- Do not immerse appliance in water or other liquids.
- Do not reach for an appliance that has fallen into water. Unplug immediately.
- Take care to avoid contact between the moving blades of the unit and the skin, paying particular attention to the face, neck and hands.
- This appliance is not intended for use by persons (including children) with reduced physical, sensory or mental capabilities, or lack of experience and knowledge, unless they have been given supervision or instruction concerning use of the appliance by a person responsible for their safety.
- Children should be supervised to ensure that they do not play with the appliance.
- This appliance contains batteries that are non-replaceable.

WARNING: For purposes of recharging battery, only use detachable supply unit CA10 provided with this appliance.

IMPORTANT: Always unplug the appliance when not in use or before cleaning. Do not leave unattended when plugged in or switched on. Do not place on any heat sensitive surface.

- Do not use any attachments other than those supplied by Conair Australia Pty Ltd.
- Use this appliance only for its intended use as described within this instruction booklet.
- Always unplug the appliance when fully charged.
- This appliance is not intended for commercial use.
- Never drop or insert any object into an opening.
- Do not use the appliance with damaged or broken attachment combs or with any teeth missing from the blades, as injury may occur.
- Do not place on any surface while it is operating.
- Do not use an extension cord with this appliance.
- Do not use outdoors or operate where aerosol (spray) products are being used or where oxygen is being administered.
- Do not use the appliance if it is damaged. In the event of damage, discontinue use immediately and contact your dealer for instructions on returning it for examination or exchange.
- Always ensure that the voltage to be used corresponds to the voltage marked on the unit.
- For additional protection, the installation of a residual current device (RCD) with a rated operating current not exceeding 30mA is advisable in the electrical current circuit supplying the bathroom. Ask your installer for advice.
- The appliance is only to be used with the power supply unit provided with the appliance.

THE CLEAN CUT

HEY MAN, IT'S CLIPPING TIME.

The Clean Cut is the essential hair clipping kit with colour-coded guides for a perfect cut, every time.



1. Diamond sharpened blades
2. DC direct drive motor
3. Cordless use
4. 8x coloured and number-coded cutting comb guides - Grades #1 - #8 comb guides

5. 2x left + right ear taper cutting comb guides for the finishing touches around the ears

6. 5 position taper control
7. Barber comb
8. Scissors
9. Blade guard
10. Storage pouch
11. Cleaning brush
12. Oil

PREPPING YOUR NEW TOOL

CHARGING

The Clean Cut hair clipper is so easy to use. But before you start using your new tool, you must take the time to charge it overnight for **16 hours** before its first use. Your new tool comes with a small amount of charge, but the initial charge will ensure your new tool will have optimum power performance to give you smooth fast cutting, every time.

- Before using for the first time, fully charge your new tool continuously for 16 hours.
- Maximum battery capacity will only be reached after 3 charging & discharging cycles.
- Ensure your new tool is switched off.
- Insert the small plug on the charging adaptor into the socket on the bottom of your new tool.
- Plug the charging adaptor into a suitable mains power socket and switch on.
- The red charging LED indicator light on your new tool will remain on when correctly connected to the mains power.
- A full charge will supply 60 minutes cordless runtime.
- To maintain optimum capacity of the rechargeable battery, it is highly recommended to fully discharge & then recharge your tool for 16 hours every 6 months.

MAINS OPERATION

The clipper should not be used for longer than 20 minutes when operated from the mains.

NOTE - if the battery is weak and low on battery charge, wait approx. 1 min before switching the clipper on.

HOW TO USE THE CLEAN CUT

BEFORE USING

- Always inspect the clipper blades for noticeable signs of damage.
- Ensure the clipper blades are well oiled before using.
- Always inspect the clipper blades before use to ensure they are free from hair, debris etc.
- Ensure the clipper is sufficiently charged before use.
- For best performance use on clean, dry hair that has been combed until tangle-free.

OILING THE BLADES

To get the sharpest, most precise cut, it is highly recommended to oil the blades before each use.

Using the oil supplied with your new tool, unscrew the cap & cut off the very end of the plastic tube with a pair of scissors to release the oil.

Switch your tool on, gently squeeze the oil tube & apply 2 drops of oil onto the blades. Leave the tool on for a further few seconds to allow the oil to thoroughly spread across each of the blades. Switch off the tool & remove any excess oil by gently dabbing with a cloth.

5 POSITION TAPER CONTROL

The 5 position taper control for is designed for blending layers & a precise close trim, every time.

- To increase the cutting length, push the lever down.
- To reduce the cutting length, push the lever up.

EASY CLIPPING, YOUR WAY

The Clean Cut features 8 cutting comb guide from grades #1 – 8 comb guides (3mm to 25mm) for cutting, shaping & fading and left + right ear taper cutting comb guides for the finishing touches around the ears.

The comb guides are colour-coded and also marked with the following grade numbers:

Cutting Length	Grade
3mm	#1
6mm	#2
9.5mm	#3
13mm	#4
16mm	#5
19mm	#6
22mm	#7
25mm	#8
Ear taper	Left
Ear taper	Right

- To attach a comb guide, ensure the appliance is switched off. Position the comb guide over the front of the clipper blade and slide over the head. Push and click the rear of the comb guide into position.
- To remove the comb guide, ensure the appliance is switched off. Push the tab on the rear of the comb guide away from the head and lift off.
- To attach the ear comb guides, choose either the left or right guide depending on which ear you are cutting above. Angle the clipper and gently stroke around the ear towards the back of the neck.

CLIPPING TIPS

CHECK OUT CONAIRMAN.COM.AU FOR GROOMING TIPS & KNOW HOW TO LET YOU CRAFT A REPUTATION

CREATING AN ALL-OVER EVEN CUT

1. Ensure the clipper is switched off.
2. Attach the desired cutting comb guide as required.
3. Switch the clipper on – the blades will start to move.
4. Start cutting at the nape of the neck, holding the clipper with the teeth of the clipper pointing upwards, ensuring that the comb guide is resting flat against the head.
5. Slowly move the clipper upwards and outwards through the hair towards your crown, against the direction of the hair growth. The comb guide will help to lift the hair and the blades will cut the hair to the length as shown on the comb guide.
6. Once the desired length is achieved at the back of the hair, start clipping the top and sides.
7. Hold the clipper to the front of your hair with the teeth pointing towards the back of your head, and move the clipper towards your crown. Repeat as necessary, moving in rows from the front and the sides of your head to the back.
8. For finishing around the ears, attach the required ear taper comb guide and trim down any longer hairs around the ears.

CREATING A SHORT BACK & SIDES LOOK, WITH LENGTH ON THE TOP

1. Ensure the clipper is switched off.
2. Attach the desired cutting comb guide as required.
3. Switch the clipper on – the blades will start to move.
4. Hold the clipper to the front of your hair with the teeth pointing towards the back of your head and move the clipper towards your crown. Repeat as necessary, moving in rows from the front and the sides of your head to the back.
5. If you then wish to take the back and sides of your hair to a shorter length, switch off the appliance and attach a shorter comb guide.
6. Start cutting at the nape of the neck, and with the comb guide flat against the head, move the clipper upwards and outwards over the area you want to take shorter.
7. Repeat on the sides of the hair, starting with the teeth of the clipper pointing upwards and comb guide flat against the area above the ear, again moving the clipper upwards and outwards.

OUTLINING

1. To tidy up the edges around your cut e.g. neckline and sideburns, detach the comb guides.
2. Hold the clipper upside down, so the front of the clipper is facing towards your head.
3. Hold the clipper straight on your sideburns or neckline and move the clipper downwards. This will give you a clean, smooth finish.

CLIPPER CLEANING & MAINTENANCE

Because the clipper blades are precision made for a very special use, they should always be handled with care. To ensure long-lasting performance of your clipper, it is important to clean the blades + the comb guides after every use.

After each use, clean the clipper blade set as follows:

1. Switch the clipper off or unplug from the power outlet if it is charging.
2. Remove the blade set from the clipper as shown below (fig 1).
3. Using the cleaning brush, gently brush and blow any hairs from the blade set and head of your clipper.
4. Replace the blade set as shown below (fig 2). Make sure that the taper lever is set to the lowest position before replacing blade set.
5. Do not disassemble the blades for cleaning.
6. After replacing the blade set, always remember to oil the blade of your clipper.



Fig. 1

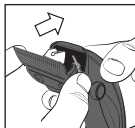





Fig. 2

WORLDWIDE VOLTAGE

This appliance has a multi voltage feature for worldwide use. The voltage automatically converts for ease of use from 100v - 240v. This appliance has an automatic internal converter which will automatically convert the voltage without the need of a switch. A suitable plug adaptor will be required, please refer to the chart below.

Plug adaptor required	Voltage and plug adaptors	Country	Voltage setting
	British plug: 240V	Ireland, Great Britain, Singapore, South America, Hong Kong (parts only), Africa (parts only)	240V
	European plug: 240V	Asia, Europe, Middle East Noumea, Scandinavia, South America, Hong Kong (parts only)	240V
	Australian and New Zealand plug: 230-240V	Australia, New Zealand	230-240V
	American plugs: 120V	North America, Japan, Canada (parts of)	120V

BATTERY DISPOSAL

The Clean Cut clipper contains a Nickel Metal-Hydride battery. To protect the environment, the appliance must be disposed of safely at the end of its useful life.



Please take the appliance to a recycling centre, where the internal rechargeable battery should be removed by a professional and recycled separately.

For more information about the recycling of electrical and battery operated appliances, please contact your local council office or your household waste disposal service.

LIMITED TWO YEAR WARRANTY

Our goods come with guarantees that cannot be excluded under the Australian Consumer Law. You are entitled to a replacement or refund for a major failure and for compensation for any other reasonably foreseeable loss or damage. You are also entitled to have the goods repaired or replaced if the goods fail to be of acceptable quality and the failure does not amount to a major failure. In New Zealand our goods come with a guarantee that cannot be excluded under the Consumer Guarantee Act 1993.

Conair Australia Pty Ltd. will repair or replace (at our option) your appliance free of charge for twenty-four months from the date of purchase if the appliance is defective in workmanship or materials.

This warranty is an additional benefit and does not affect your legal rights. To obtain service under this warranty, please retain this section of the instruction booklet with your receipt/proof of purchase. You must present it to obtain replacement or service under the warranty.

The warranty may only be claimed where proof of original purchase is presented, i.e. original purchase receipt or invoice. Attach a copy of your purchase receipt and store in a safe place.

To make a warranty claim, call or email Conair Customer Service or you can return the defective product back to the place it was purchased where it will be replaced (see Point 12 in Conditions). Please provide the following details:

1. Date of purchase
 2. Retailer Name & Location:
 3. Product Name/Model Number:
 4. Confirm you have your purchase receipt:
 5. Detail the problem with your product:
-

**TO MAKE A WARRANTY CLAIM YOU MUST
RETAIN YOUR PROOF OF PURCHASE.**

WARRANTY AGAINST DEFECTS

A. AUSTRALIAN CONSUMER LAW

1. Our goods come with guarantees that cannot be excluded under the Australian Consumer Law. You are entitled to a replacement or refund for a major failure and compensation for any other reasonably foreseeable loss or damage. You are also entitled to have the goods repaired or replaced if the goods fail to be of acceptable quality and the failure does not amount to a major failure.
2. The guarantees under the Australian Consumer Law ("ACL") are provided in sections 51 to 59 inclusive of the ACL ("Statutory Guarantees") and the remedies are provided in sections 259 to 266 inclusive of the ACL ("Statutory Remedies").

B. CONAIRMAN EXTENDED WARRANTY

1. In addition and subject to the Statutory Guarantees and Statutory Remedies, the following express warranty ("Warranty") commences from the date of purchase and continues for a period of 24 months ("Warranty Period") after which it expires. Subject to the conditions in Section C below, Conair warrants to the original purchaser ("Purchaser") of the ConairMan product that is the subject of this warranty ("Product") that if during the Warranty Period, the Product suffers from any defect caused by faults in materials or workmanship, Conair will a) replace the Product, or b) exchange defective parts in the Product or c) repair the Product, as Conair may choose in its discretion ("Warranty"). In this Warranty "Conair" means Conair Australia Pty Limited (ABN 64 068 492 044) of The Equinox Centre, Suite 101, 18Rodborough Rd, Frenchs Forest, NSW, 2086. in relation to Products purchased in Australia and Conair New Zealand Ltd in relation to Products purchased in New Zealand.
2. To honour the Warranty, Conair must replace, or exchange parts in, or repair, the Product, as Conair determines, in accordance with paragraph B1 above, subject always to the conditions in Section C below.
3. If any of the conditions in Section C below are inconsistent with any provisions of the ACL or regulations made there under, those provisions of the ACL or regulations shall prevail to the extent of the inconsistency.

C. CONDITIONS

1. The Product must be used in accordance with manufacturer's instructions. This Warranty does not apply should the defect in or failure of the Product be attributable to misuse, abuse, accident, act of God such as lightning, or nonobservance of manufacturer's instructions on the part of the user. This Warranty does not cover ordinary wear and tear in the Product or its parts.
2. Conair does not accept liability for a) any loss or damage however suffered, caused by or arising out of any failure to use the Product in accordance with the manufacturer's instructions, and b)

any indirect, consequential or economic loss or damage however caused.

3. This Warranty is immediately void if – a) any serial number or appliance plate is removed or defaced, b) the Product has been serviced or otherwise repaired by a person not authorized to do so by Conair or where non approved replacement parts are used.
4. The Product is designed for domestic use only. The Product must be connected to the electrical voltage supply as specified in the ratings label located on the Product. This Warranty does not cover defects arising from non-domestic use or incorrect voltage supply.
5. This Warranty may only be claimed against where proof of original purchase is presented, for example, original receipt or invoice.
6. Any parts of the Product that need to be replaced, or if the whole Product needs to be replaced, the replaced Product, become the property of Conair. The Warranty on any replacement Product or parts will expire on the same date that the Warranty Period on the original Product expires.
7. The benefits provided by this Warranty are in addition to all other rights and remedies in respect of the Product which the Purchaser has under the ACL, and applicable laws in New Zealand, which rights and remedies by law may not be excluded. All other warranties and representations express and implied are hereby excluded.
8. The defect must have occurred during the Warranty Period and Purchaser bears the onus of proving that fact, and that the defect was not caused by any of the causes excluded from this Warranty.
9. This Warranty does not cover Products purchased from any person who is not a retailer serviced by Conair's authorised distributors or purchased second hand.
10. The Purchaser is responsible for all postage and freight charges and any other expenses incidental to claiming against this Warranty.
11. The Warranty excludes consumable items (such as blades or brushes) and normal wear and tear.
12. If you're certain your product is defective, and the product is covered by the terms of this warranty, you need to take the product back to the place you purchased it from, where the retailer will replace the product for you on our behalf. In this event, per the terms of this warranty you will need to present this portion of the warranty card and the purchase receipt as proof of purchase so please make sure you keep both this card and your receipt on hand for the duration of the warranty period.

SPARE PARTS

Replacement parts may be available for your product. Contact us on the phone or email address provided for more details. Please provide your product name/model number details, date of purchase and part you require.



©2023 Conair Australia Pty. Ltd.
Suite 101, 18 Rodborough Rd
Frenchs Forest NSW 2086
Australia

Conair New Zealand Limited
PO BOX 251159
Pakuranga, Auckland 2140
New Zealand

CONTACT US

For advice & tips on your new ConairMan product email us on:
aus_info@conair.com

CUSTOMER SERVICE

Australia: 1800 650 263
New Zealand: 0800 266 247

Check out CONAIRMAN.COM.AU for grooming tips & know how to let you craft a reputation.

CONAIRMAN™

**CRAFT A
REPUTATION,
MY MAN**