

CONAIRMAN™



XPERT GROOM™

TOOL TIPS

for the all-in-one grooming kit with premium performance
& advance technology, for EXPERT results.

VSM890MA

HERE YOU ARE.

RIGHT WHERE YOU NEED TO BE, MAN.

FROM THE STREETS OF
BROOKLYN, NEW YORK

**WE ARE CHANGE
MAKERS & STYLE CREATORS.**

WE'VE FOUGHT OUR WAY INTO
YOUR HANDS TO HELP YOU CRAFT
**A REPUTATION, NOT JUST ENGAGE
IN SOME BRILLIANT GROOMING.**

KNOW YOUR WORTH, INVEST IN IT MAN & CHECK OUT OUR INSIDER
KNOWLEDGE, TIPS & TRICKS TO MAKE THE MOST OF THE STYLE PATH
YOUR FEET ARE FIRMLY PLANTED ON. GIDDY UP, IT'S GROOMING TIME.

CHECK OUT CONAIRMAN.COM.AU FOR GROOMING TIPS
& KNOW HOW TO LET YOU CRAFT A REPUTATION

CONAIRMAN™

**CRAFT A
REPUTATION,
MY MAN**

IMPORTANT SAFETY INSTRUCTIONS

When using electrical appliances, especially when children are present, basic safety instructions should always be followed, including the following:

Polythene bags over product or package may be dangerous. To avoid danger of suffocation, keep this wrapper away from babies and children. This bag is not a toy.

DANGER: When the unit is used in a bathroom, unplug it after use since the proximity of water presents a hazard even when the appliance is switched off.



WARNING: Do not use or leave the AC power adaptor in a position where it can become wet or there is a danger of it falling into a basin or other vessels containing water. Keep the appliance dry, unless it otherwise specified. Do not use this appliance in or near bathtubs, showers, basins or other vessels containing water.

- Do not immerse appliance in water or other liquids.
- Do not reach for an appliance that has fallen into water. Unplug immediately.
- Take care to avoid contact between the moving blades of the unit and the skin, paying particular attention to the face, neck and hands.
- This appliance is not intended for use by persons (including children) with reduced physical, sensory or mental capabilities, or lack of experience and knowledge, unless they have been given supervision or instruction concerning use of the appliance by a person responsible for their safety.
- Children should be supervised to ensure that they do not play with the appliance.
- For purposes of recharging battery, only use detachable supply unit provided with this appliance.
- This appliance contains batteries that are non-replaceable.

IMPORTANT: Always unplug the appliance when not in use or before cleaning. Do not leave unattended when plugged in or switched on. Do not place on any heat sensitive surface.

- Do not use any attachments other than those supplied by Conair Australia Pty Ltd.
- Use this appliance only for its intended use as described within this instruction booklet.
- Always unplug the appliance when fully charged.
- This appliance is not intended for commercial use.
- Never drop or insert any object into an opening.
- Do not use the appliance with damaged or broken attachment combs or with any teeth missing from the blades, as injury may occur.
- Do not place on any surface while it is operating.
- Keep the cord away from heated surfaces.
- Never twist or pull on the power cord.
- Do not use an extension cord with this appliance.
- After use do not wrap the cord around the appliance as in time this may cause the cord to fracture. Coil cord loosely by the side of the appliance in storage.
- Do not use outdoors or operate where aerosol (spray) products are being used or where oxygen is being administered.
- Do not use the appliance if it is damaged. In the event of damage, discontinue use immediately and contact your dealer for instructions on returning it for examination or exchange. If the supply cord is damaged, it must be replaced by the manufacturer, its service agent or similarly qualified person in order to avoid a hazard.
- Always ensure that the voltage to be used corresponds to the voltage marked on the unit.
- For additional protection, the installation of a residual current device (RCD) with a rated operating current not exceeding 30mA is advisable in the electrical current circuit supplying the bathroom. Ask your installer for advice.
- The appliance is only to be used with the power supply unit provided with the appliance.

THE XPERT GROOM

STEP UP, IT'S GROOMING TIME.

The XPERT GROOM is the all-in-one grooming kit with premium performance & advance technology, for EXPERT results.



1. Premium 34mm Japanese steel blades
2. Lithium-ion powered for long lasting 120min runtime
3. Cordless use
4. 6 position stubble guide (1mm to 3.5mm) for short or shadow stubble

5. 7 position beard comb guide (2mm to 14mm) for keeping your beard in top shape
6. Facial foil shaver
7. Body groomer foil shaver
8. 3mm body comb guide
9. 5mm body comb guide
10. 7mm body comb guide

11. 16mm precision detail trimming blade
12. 3mm eyebrow comb guide
13. 5mm eyebrow comb guide
14. Rotary blade
15. Travel storage case
16. Cleaning brush
17. Oil

PREPPING YOUR NEW TOOL

CHARGING

The XPERT GROOM is so easy to use. But before you start using your new tool, you must take the time to charge it for **3 hours** before its first use. Your new tool comes with a small amount of charge, but the initial charge will ensure your new tool will have optimum power performance to give you smooth fast cutting, every time.

- Before using for the first time, fully charge your new tool continuously for 3 hours. After the first charge a full charge will only take 120 minutes.
- Maximum battery capacity will only be reached after 3 charging & discharging cycles.
- To charge the trimmer, insert the small plug on the charging adaptor into the hole on the base of the trimmer.
- When charging the trimmer, the blue LED charging light will flash slowly & continuously until the battery has fully charged, then the blue LED charging light will stop flashing but remain on.
- 2 hours full charge will supply 120 minutes cordless runtime.
- A quick charge of 20 minutes provides 20 minutes cordless runtime.
- To maintain optimum capacity of the rechargeable battery, it is highly recommended to fully discharge & then recharge your tool for 3 hours every 6 months.
- When the trimmer is running low on charge, the blue LED indicator light will flash. This indicates that the trimmer needs to be recharged, however it may continue to run for a very short while after
- If the blue LED suddenly starts to flash rapidly then the appliance is faulty. If this happens then please stop charging & remove the adaptor from the mains & contact our customer care centre for further advice (see the "warranty section" section of the information booklet).

HOW TO USE THE XPERT GROOM

CHECK OUT **CONAIRMAN.COM.AU** FOR GROOMING TIPS &
KNOW HOW TO LET YOU CRAFT A REPUTATION

BEFORE USING

- Always inspect the trimmer blades for noticeable signs of damage.
- Always inspect the trimmer blades before use to ensure they are free from hair, debris etc.
- Ensure the trimmer is sufficiently charged before use.
- If the foil shaver heads are cracked, broken or loose, do not use it again & replace with a new foil. Using a foil in a faulty condition can cause injury.
- Do not shave on open wounds, cuts, burns, warts, moles or on sunburned skin.
- Do not use the foil shaver if you suffer from skin irritations or infections, such as psoriasis or eczema. If at all unsure always consult your doctor before use.

CHANGING THE HEADS

- Before changing the heads, ensure the trimmer is switched off.

Remove all comb guides.

- To remove the head, twist anti-clockwise then pull off. (Fig. 1).
- To attach the head, align the markers, slide the head on & twist the head clockwise to lock into place (Fig. 2).

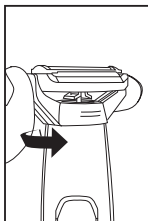

(Fig. 1: REMOVE)

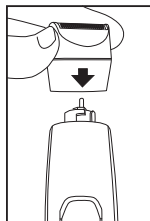
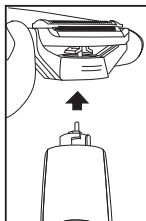

(Fig. 2: ATTACH)

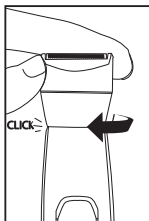

ATTACHING THE 34MM PRECISION TRIMMING BLADE

WITH 7-POSITION COMB GUIDE:

- Ensure the appliance is switched off.
- Attach the Precision Trimmer Blade.
- Align the comb guide with the locking release button (on the back of the trimmer), as per Fig 2.
- Depress the locking release button with your thumb & slide the comb guide in place until you hear a click.
- The comb guide will be set to the shortest length when the comb guide is fully pressed down.
- To adjust the comb guide settings, depress & hold the lever with your thumb on the back of the guide, sliding the guide up or down to the required length (2-14mm).



- The comb guide has 7 positions; 2mm, 4mm, 6mm, 8mm, 10mm, 12mm & 14mm.
- The setting selected is shown in the back of the comb guide window.
- To remove the comb, depress the locking release button (on the back of the trimmer handle) & pull the comb guide upwards to remove, as per Fig 3 & 4.

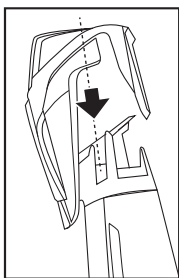

Fig 1

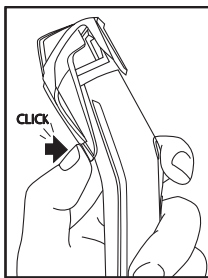

Fig 2

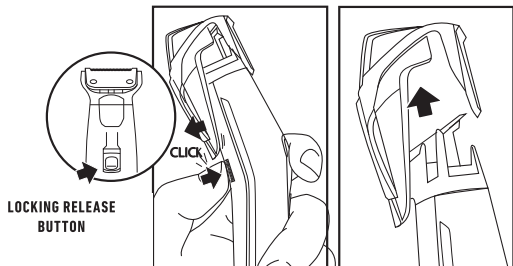

Fig 3

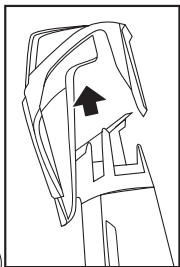

Fig 4

Attaching 6 position stubble comb guide

- The stubble comb with 6-position switch enables super fine cut adjustment for precision trimming.
- Attach stubble comb by sliding the head onto the tracks at each side of the 34mm detail trimming blade, push one side at a time until you hear a click.
- Choose a length between 1-3.5mm in 0.5mm increments. Slide the switch across, so the line is lined up with the desired length.
- To remove, push the sides of the comb guide with your finger & thumb & push up until you hear a click.

**TRIMMING****Attaching the body groomer foil shaver attachments**

- Ensure the appliance is switched off
- Attach the body groomer head by aligning the marker, sliding the head on & twisting clockwise to lock in place.
- Attach the comb guide by placing on top of the body groomer head & pressing down.
- To remove the body groomer comb guide, push the sides of the comb guide in with your finger & thumb & push up until you hear a click.
- To remove the body groomer foil shave attachment, twist the head anti-clockwise & then pull off.

Attaching the 16mm detail trimmer blade attachment

- Ensure the appliance is switched off
- Attach the 16mm detail trimmer blade by aligning the marker, sliding the head on & twisting clockwise to lock in place.
- Attach the comb guide by placing on top of the body groomer head & pressing down.
- To remove the comb guide, push the sides of the comb guide in with your finger & thumb & push up until you hear a click.
- To remove the 16mm detail trimmer blade attachment, twist the head anti-clockwise & then pull off.

Attaching the 34mm precision trimming blade with 7-position comb guide (2-14mm) or attaching the stubble comb guide (1-3.5mm)

- Attach the 7-position comb guide & select the required length (2-14mm).
- If you require more than one cutting length, start with the longest length first.
- Switch the trimmer on.
- Hold the trimmer with the teeth of the trimmer pointing upwards, yet flat against the skin.
- Move the trimmer upwards & outward through the hair, against the direction of hair growth.
- The trimmer will work most efficiently when cutting through hair at its own speed.
- Never switch the appliance off whilst in the hair.

Note: The Precision Trimmer can be used without any comb guides & will cut roughly to a length of 0.5mm.

USING THE 34MM PRECISION TRIMMING BLADE

- Do not attach a comb guide.
- Hold the trimmer upside down with the blade facing downwards, yet flat against the skin.
- Move the trimmer gently downwards in small strokes around the edge of the area you wish to outline.
- Having defined the outline, hold the trimmer with the blades pointing upwards, yet flat against the skin & move the trimmer upwards against the direction of hair growth. This will trim the unwanted hair adjacent to the outline.



USING THE BODY GROOMER FOIL SHAVER

The foil shaver has been specially designed for shaving all bodyzones - chest & stomach area, back & shoulders, underarms, legs & the groin area. It will leave the skin feeling clean, smooth & refreshed. The dual independent trimmers on either side of the foil shaver are designed to shorten long hair along with the 3mm, 5mm or 7mm comb guides can vary the trimming length.

PREPARING THE SKIN

Before using the foil shaver, make sure that the skin is perfectly lean & free from grease or cream. Exfoliating the skin once or twice a week before shaving helps to maintain healthy & fresh skin, but it also helps to:

- Prevent hairs from growing under the skin, resulting in in-grown hairs
- Remove dead skin cells & refine the texture of your skin, resulting in a closer shave
- Prepare your skin to help it absorb skin care products.

We recommend exfoliating ideally the day before, as well as just before shaving. This will help straighten the hair & make it easier to shave. Avoid exfoliating just after shaving.

Having a warm shower before use will also help to soften the hair.

1. Attach the body groomer foil shaver head.
2. Attach a comb guide if a longer length is required. Switch the trimmer on.
3. Always keep the shaver flat to the surface to be shaved.
4. Always work with both hands: stretch the skin with one hand & move the trimmer with the other hand.
5. Slowly move the shaver, exerting light pressure. As a precaution, the operation of the trimmer may slow down substantially if the foil shaving head is pressed too hard against the skin.

Note: The Body Groomer can be used without any comb guides & will cut roughly to a length of 0.1mm.



USING THE FOIL SHAVER:

The facial foil shaver has been designed for sharpening & defining your look with a clean, smooth finish. You can use the facial foil shaver once you've finished trimming your beard. It's ideal for defining around the edges of your beard, stubble, front & back of the neckline.

- Always ensure the foil is not damaged before each use.
- Switch the trimmer on.
- Move the shaver gently over the skin, applying minimal pressure & shaving in the direction of hair growth.
- Make sure to be particularly careful when trimming sensitive areas.
- Never switch the appliance off whilst in the hair.



USING THE NOSE & EAR TRIMMER:

For the safe & easy removal of unwanted nose & ear hair use the rotary trimmer head.

- Switch the trimmer on.
- Insert the trimmer into the nose or ear & gently move the trimmer in a circular motion.
- Only use the trimmer at the entrance to the ear or nose. Do not use any deeper, as this could cause injury.
- Never turn the trimmer off whilst in the nose & ear hair.



USING THE DETAIL TRIMMER:

For final finishing & detailing of your beard, sideburns or neck area. Includes 3mm & 5mm eyebrow comb guides.

- Switch the trimmer on.
- Gently move the blade through the area of hair you wish to trim.
- The trimmer will work most efficiently when cutting through hair at its own speed.
- Never turn the trimmer off whilst in the hair.
- To groom eyebrows, clip the comb guide over the blade. start with the 5mm first, reducing to 3mm if required.



TRIMMER CLEANING & MAINTENANCE

Because the trimmer blades are precision made for a very special use, they should always be handled with care. To ensure long-lasting performance of your trimmer, it is important to clean the blades + the comb guides after every use.

To remove the trimming blade, follow the instructions at CHANGING THE ATTACHMENT HEADS.





1. First, take the cleaning brush & brush away any loose hairs that have collected in the blades.
2. Rinse the trimming blades under running water. The comb guides can also be rinsed separately.
3. After cleaning, make sure to shake off excess water & dry the head of the trimming blades + comb guide before replacing onto the handle.
4. Do not disassemble the blades.

OILING THE BLADES

Periodically, it may be necessary to oil the blades. After cleaning, attach a trimmer head, switch on & oil the blades using a few drops of the lubricating oil supplied. Only use the lubricating oil supplied with the appliance as this is specifically formulated for high speed trimmers & does not evaporate or slow the blades.

WORLDWIDE VOLTAGE

This appliance has a multi voltage feature for worldwide use. The voltage automatically converts for ease of use from 100V - 240V. This appliance has an automatic internal converter which will automatically convert the voltage without the need of a switch. A suitable plug adaptor will be required, please refer to the chart below.

Plug adaptor required	Voltage and plug adaptors	Country	Voltage setting
	British plug: 230V	Ireland, Great Britain, Singapore, South America, Hong Kong (parts only), Africa (parts only)	230V
	European plug: 230V	Asia, Europe, Middle East Noumea, Scandinavia, South America, Hong Kong (parts only)	230V
	Australian and New Zealand plug: 230-240V	Australia, New Zealand	230-240V
	American plugs: 120V	North America, Japan, Canada (parts of)	120V

PLEASE TAKE THE APPLIANCE TO A RECYCLING CENTRE, WHERE THE INTERNAL RECHARGEABLE BATTERY SHOULD BE REMOVED BY A PROFESSIONAL AND RECYCLED SEPARATELY.

BATTERY DISPOSAL

The XPERT GROOM contains a Li-ion battery. To protect the environment, the appliance must be disposed of safely at the end of its useful life.



Li-ion

Please take the appliance to a recycling centre, where the internal rechargeable battery should be removed by a professional & recycled separately.

For more information about the recycling of electrical & battery operated appliances, please contact your local council office or your household waste disposal service.

**FOR MORE INFORMATION ABOUT RECYCLING
OF ELECTRICAL AND BATTERY OPERATED
APPLIANCES, PLEASE CONTACT YOUR LOCAL
COUNCIL OFFICE OR YOUR HOUSEHOLD WASTE
DISPOSAL SERVICE.**

WARRANTIES

1. In this warranty document ("Warranty Document"), "Conair", "we" or "us" means:

- Conair Australia Pty Limited (ABN 64 068 492 044) of The Equinox Centre, Suite 101, 18 Rodborough Rd, Frenchs Forest, NSW, 2086, in relation to products purchased in Australia; or Conair New Zealand Ltd of Conair New Zealand Limited, PO BOX 251159 Pakuranga, Auckland 2140, New Zealand in relation to products purchased in New Zealand.
- Nothing in this Warranty Document limits or reduces (or purports to limit or reduce) any statutory guarantees pursuant to the Australian Consumer Law for Australian customers or the Consumer Guarantees Act 1993 for New Zealand customers.
- If you have any questions about the product you have purchased in either Australia or New Zealand, please contact us on 1800 650 263 (for Australian customers) or 0800 266 247 (for New Zealand customers). Further contact details are set out at the bottom of this Warranty Document.

STANDARD 2 YEAR (24 MONTH) WARRANTY

2. **AUSTRALIA:** Our goods come with guarantees that cannot be excluded under the Australian Consumer Law. You are entitled to a replacement or refund for a major failure and compensation for any other reasonably foreseeable loss or damage. You are also entitled to have the goods repaired or replaced if the goods fail to be of acceptable quality and the failure does not amount to a major failure.
NEW ZEALAND: Our goods come with guarantees that cannot be excluded under the Consumer Guarantees Act 1993. This guarantee applies in addition to the conditions and guarantees implied by that legislation.
3. Conair's name, postage address, email and phone number are available at the bottom of this Warranty Document, under "Contact Information".
4. This Standard 2 Year (24 Month) Warranty ("Standard Warranty") applies for a period of 2 years (24 months) from the date that you purchased your product ("Standard Warranty Period"). For clarity, the relevant defect must appear within the Standard Warranty Period timeframe for this Standard Warranty to apply.
5. If your product is defective, and the product is covered under this Standard Warranty, you should, in the first instance, take the product back to the place you purchased it from or

contact us directly if you are unable to take the product back to the place of purchase. The procedure for claiming under this Standard Warranty is as detailed below.

6. To make a Standard Warranty claim, you will need to return the defective product back to the place it was purchased where it will be assessed under this Standard Warranty. Or if you are unable to return the defective product back to the place of purchase, you will need to call our Customer Service team on 1800 650 263 (for Australian Customers) or 0800 266 247 (for New Zealand customers) or send an email to the email address provided below under 'Contact Information'.
7. **In order to make a claim under this Standard Warranty, you will need to provide the following details to Conair:**
 1. **Date of purchase**
 2. **Retailer name & location**
 3. **Product model number & name**
 4. **Confirm you have your purchase receipt**
 5. **Detail the problem with your product.**
8. If you make a Standard Warranty claim directly with us, we will ask for you to send us back the defective product along with the purchase receipt. To do this, please head to your local post office and send the product to our reply paid address which is: Reply Paid 146, PO Box 146, Terrey Hills NSW 2084. For clarity, we will be responsible for covering the cost of postage to the above reply paid address.
9. Once we receive your product, we assess it accordingly. Upon analysing the defect, we will either: a) have the product replaced and sent back to you; or b) refund you (either in part or in full).
10. The benefits provided to you under this Standard Warranty are in addition to other rights and remedies available to you under consumer law.
11. Within the Standard Warranty Period, if your product suffers a defect in the materials or workmanship, Conair will either refund or replace your product, in our sole discretion, for no charge.
12. Under this Standard Warranty, we do not have to refund, repair or replace your product if the product's defect or damage is a result of misuse, abuse, accident, act of God such as lightning, or nonobservance of Conair's instruction booklet on the part of the user.
13. The Standard Warranty does not cover ordinary wear and tear of the product.
14. This Standard Warranty is immediately void if: a) any serial number or product plate is

removed or defaced, or b) the product has been serviced or otherwise repaired by a person not authorised to do so by Conair or where non-approved replacement parts are used.

15. You are aware that the product is designed for domestic use only and that it must be connected to the electrical voltage supply as specified in the ratings label located on the product itself and detailed in the product's instruction booklet. The Standard Warranty does not cover defects arising from non-domestic use or use of incorrect voltage supply.
16. This Standard Warranty may only be claimed where proof of original purchase is presented, for example, original receipt or invoice.
17. The Standard Warranty on any replacement product or parts will expire on the same date that the Standard Warranty Period on the original product expires, as far as the law permits.
18. In order to obtain a remedy under this Standard Warranty, the defect must have occurred during the Standard Warranty Period and you (as the purchaser) bear the onus of proving that fact, and that the defect was not caused by any of the exclusions above.
19. This Standard Warranty does not cover any product purchased from any entity who is not an authorised Conair distributor or reseller. For clarity, all warranties are only enforceable in Australia and New Zealand.
20. To the fullest extent permitted by law, Conair does not accept liability for: a) any loss or damage however suffered, caused by or arising out of any failure to use a product in accordance with Conair's instruction booklet; and b) any indirect, consequential or economic loss or damage however caused.
21. We will be responsible for all postage and freight charges and any other expenses incidental to claiming under the Standard Warranty, however you must send the product back to our Reply Paid address (which is: Reply Paid 146, PO Box 146, Terrey Hills NSW 2084).
22. If your product is defective, and the product is covered by this Standard Warranty, you should take the product back to the place you purchased it from or contact us directly using the contact information provided in the Contact Information section below.
23. To honour the Standard Warranty, you must retain your proof of original purchase, for example, original receipt or invoice and you must present the proof of original to obtain replacement, refund or service under this Standard Warranty, alongside your defective product.
24. You understand that the Standard Warranty may only be claimed where proof of original purchase is presented, i.e. original purchase receipt or invoice. When asked to do so, please provide your proof of original purchase along with the requested information/defective item.

CONAIR EXTENDED WARRANTY

25. In addition to the rights and remedies you have pursuant to law, we provide an extended warranty for your product ("Extended Warranty"), which commences from the date of purchase and continues for a period of 36 months for the **trimmer motor and rechargeable battery only** ("Extended Warranty Period") after which it expires, subject the conditions outlined in the Standard Warranty above. For the sake of clarity, all other items including blades, comb guides and consumables are covered by the Standard Warranty outlined above but are not subject to this Extended Warranty.
26. If you make an Extended Warranty claim directly with us, we will ask for you to send us back the defective product along with the purchase receipt, to our address located in our Contact Information section.
27. This Extended Warranty is immediately void if: a) any serial number or product plate is removed or defaced, or b) the product has been serviced or otherwise repaired by a person not authorised to do so by Conair or where non-approved replacement parts are used.
28. This Extended Warranty does not cover any product purchased from any entity who is not an authorised Conair distributor or reseller.
29. Under this Extended Warranty, we do not have to refund or replace your product if the product's defect or damage is a result of misuse, abuse, accident, act of God such as lightning, or nonobservance of Conair's instruction booklet on the part of the user.

SPARE PARTS

30. Replacement parts may be available for your product. Contact us on the phone or email address provided for more details. Please provide your product name/model number details, date of purchase and part you require.

CONTACT INFORMATION

Conair Australia Pty Ltd

PO Box 146 Terrey Hills NSW 2084

Customer Service

Australia

1800 650 263

email: aus_info@conair.com

Conair New Zealand Ltd

PO Box 251159 Pakuranga, Auckland New Zealand 2140

Customer Service

New Zealand

0800 266 247

email: aus_info@conair.com



©2023 Conair Australia Pty. Ltd.
Suite 101, 18 Rodborough Rd
Frenchs Forest NSW 2086
Australia

Conair New Zealand Limited
PO BOX 251159
Pakuranga, Auckland 2140
New Zealand

CONTACT US

For advice & tips on your new ConairMan product email us on:
aus_info@conair.com

CUSTOMER SERVICE

Australia: 1800 650 263
New Zealand: 0800 266 247

Check out CONAIRMAN.COM.AU for grooming tips & know how to let you craft a reputation.

CONAIRMAN™

**CRAFT A
REPUTATION,
MY MAN**

IB-22/379A